

CARBON COLLECTORS

carbon inserts

2H Type

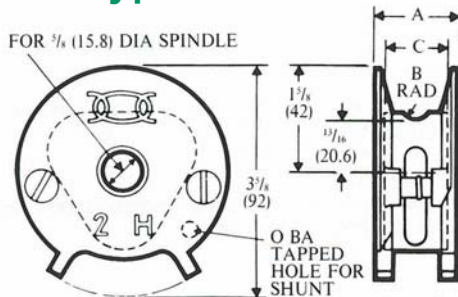

Type	Ref no	A (Inch / mm)	B (Inch / mm)	C (Inch / mm)	Grade CY3	Grade MY7D
2H	1	1 25.40	3/16 4.76	5/8 15.87	FC200	FC239
2H	1	1 25.40	3/16 4.76	3/4 19.10	FC201	FC240
2H	2	1 1/8 28.60	3/16 4.76	7/8 22.22	FC202	FC241
2H	3	1 1/4 31.75	3/8 9.52	1 25.40	FC203	FC242
2H	4	1 3/8 34.90	3/8 9.52	1 1/8 28.60	FC204	FC243
2H	5	1 1/2 38.10	3/8 9.52	1 1/4 31.75	FC205	FC244
2H	6	1 5/8 41.30	3/8 9.52	1 3/8 34.90		
2H	7	1 3/4 44.50	3/8 9.52	1 1/2 38.10	FC207	FC246
2H	7	1 3/4 44.50	3/8 9.52	2 50.80		FC250

2H Inserts

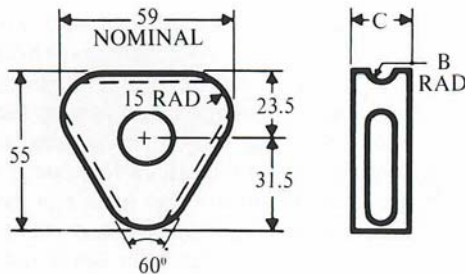

Recommended width

A=Wire diameter+11/16–17.5mm

Select next larger standard size collector

Standard size “B” as above

Dimensions in millimetres

“C” dimension	Grade CY3	Grade MY7D
5/8 15.80	FC100	FC139
3/4 19.10	FC101	FC140
7/8 22.22	FC102	FC141
1 25.40	FC103	FC142
1 1/8 28.60	FC104	FC143
1 1/4 31.75	FC105	FC144
1 1/2 38.10	FC107	FC146
2 1/4 57.10	-	FC149
2 50.80	-	FC150

